

PM Fiber Optical Switch (1x1, 1x2)

Features

- Compact Size
- Fast Response Time
- Low Insertion Loss

Applications

- Protection Switching
- Reconfiguration
- Optical Subsystems
- Array Integration

Specifications

Parameters	Unit	1x2	
Operation Wavelength	nm	1310, 1550	980~1064
Insertion Loss	dB	≤0.5 (Typ. 0.4)	≤1.2 (Typ. 0.8)
Extinction Ratio	dB	≥20	
Return Loss	dB	≥50	
Cross Talk	dB	≥55	
Power Supply	V	5	
Switch Time	ms	≤8	
Repeatability	dB	≤±0.02	
Lifetime	Cycle	>10 ⁷	
Fiber Type	---	PMF Panda Fiber	PM 980 Panda Fiber
Dimension	mm	22.3x12.1x11	
Operating Temperature	°C	-20 ~ +70	
Storage Temperature	°C	-40 ~ +85	

Pins

Control Model	Optical Path	Electrical Drive		Status Sensor					
1x2	Light Pin	Pin1	Pin5	Pin6	Pin10	Pin2-3	Pin3-4	Pin7-8	Pin8-9
Latching	P1-P2	--	--	GND	+V	Close	Open	Open	Close
	P1-P3	+V	GND	--	--	Open	Close	Close	Open
Non-Latching	P1-P2	--	--	--	--	Close	Open	Open	Close
	P1-P3	+V	--	--	GND	Open	Close	Close	Open

Package Dimension

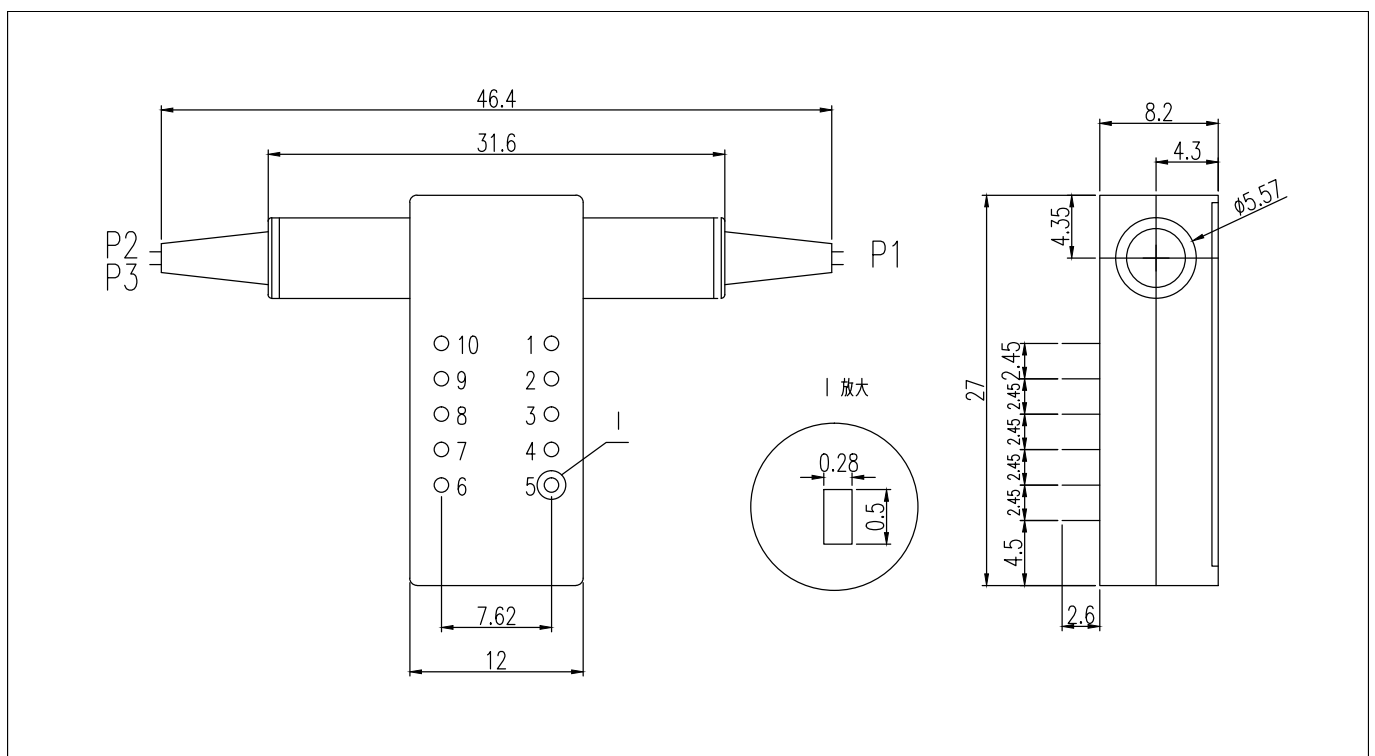

Ordering Information

PMOSW- ①①①-②②②②-③-④-⑤⑤⑤-⑥-⑦-⑧⑧

①	Port Type	1x2; 1x1;
②	Wavelength	1310; 1550; 1310/1550; 1064;
③	Voltage Type	5=5V;
④	Mode	L=Latching; N=Non-Latching;
⑤	Pigtail Type	250=250um Bare Fiber; 900=900um Loose Tube;
⑥	Fiber Type	5=PM Fiber;
⑦	Fiber Length	1= 1m;
⑧	Connector	NE=None; FA=FC/APC; FC=FC/UPC; SA=SC/APC; SC=SC/UPC; XX=Others;